

PHP2030 Main Board Assembly Replacement

For questions, clarifications or assistance call 303-670-8882

Tools Required: Phillips screwdriver, wire cutters

BEFORE BEGINNING turn the main power switch off as illustrated below and unplug the power cord.

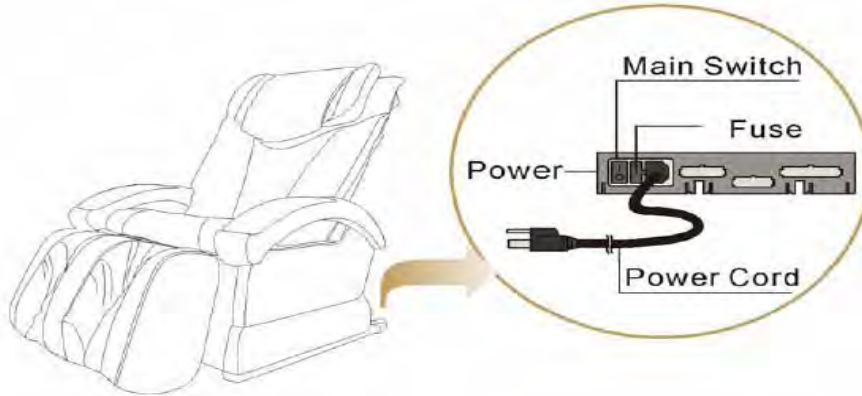

Step 1) Remove left armrest

- a) Lock the leg rest assembly up. This will allow increased access to the working area





Lift the leg rest up and, while holding it up....use your left hand to push the locking mechanism (square tubing) up. Release your hold on the leg rest assembly. The entire assembly should remain up for better access to the work area. (After completion of the entire task, lower the leg-rest by simply lifting the entire assembly up which will automatically release the lock).

b) Remove the Phillips screws holding the vanity panel onto chair and remove panel.

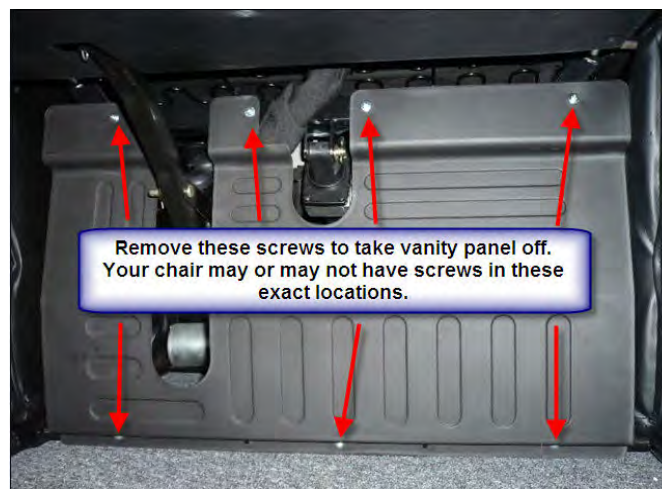

- b) Remove the thumbscrew behind the vanity panel on the left side arm and then the 2 thumbscrews from Left side at the rear of the chair. The armrest insert will then pull straight out from side.

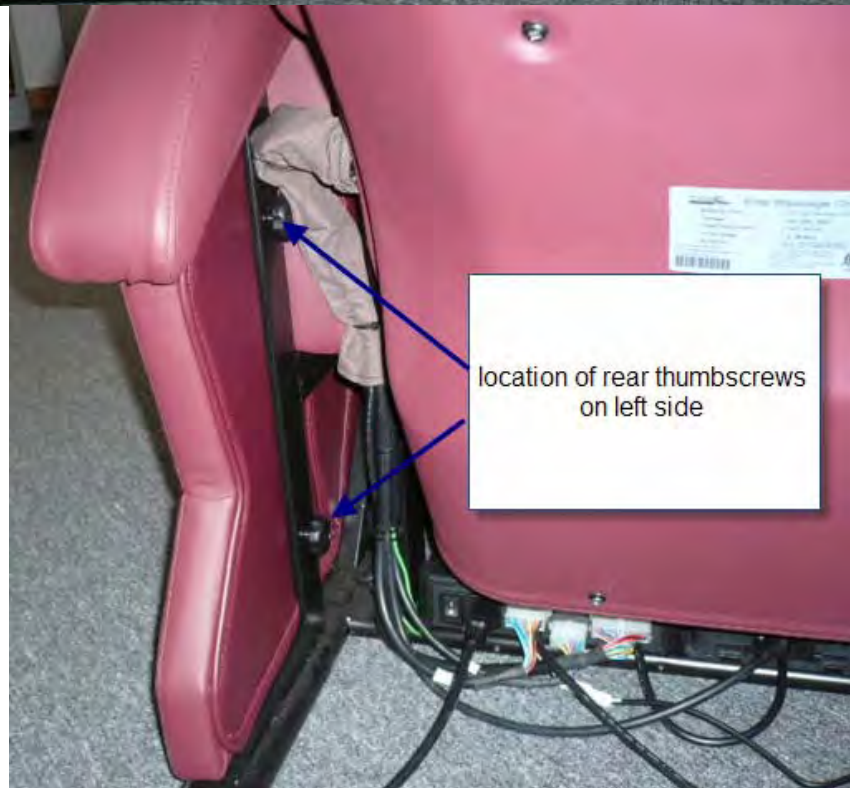
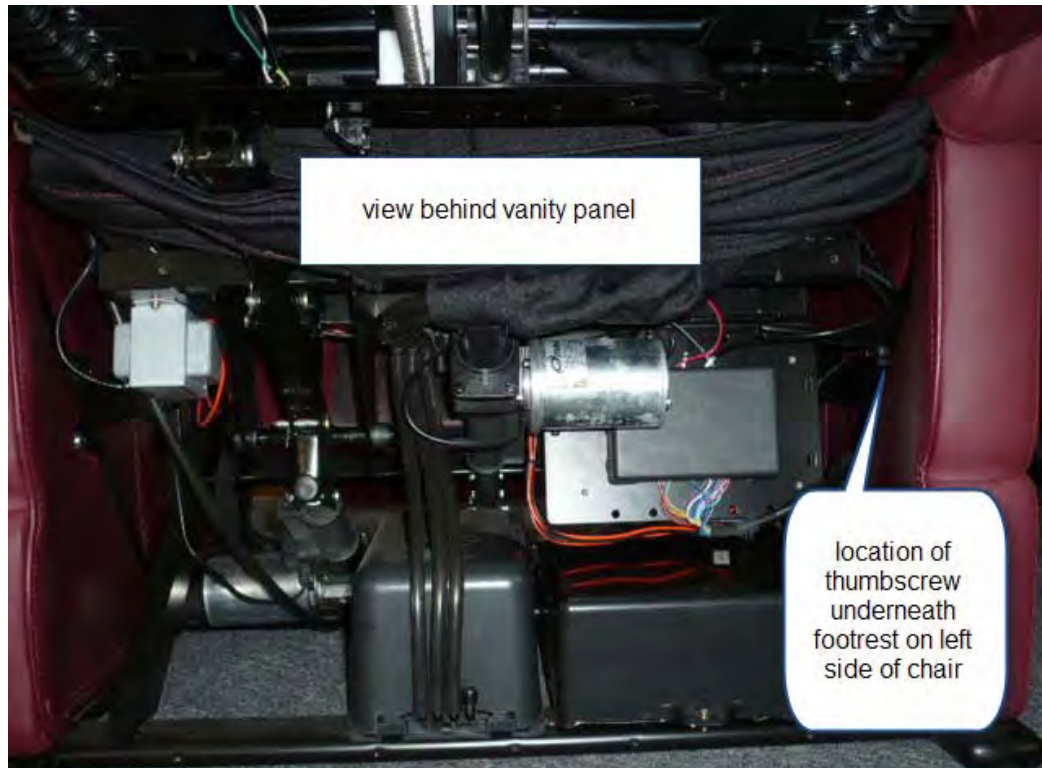



Step 2) Lay backrest forward between armrests



Reach under the back of the chair with your right hand.....about 6” in from the left side and about 4” in from the back cover. Locate the latch mechanism with a finger and pull latch out to release.



CAUTION, when the latch is release it will be free weight and will pivot.
Hold the top of the chair and lay forward gently.



Hold onto the seat back until it is firmly lying on the seat. *DO NOT ALLOW chair back to 'drop'*

The location of the components accessed in steps 3-7 are shown below.

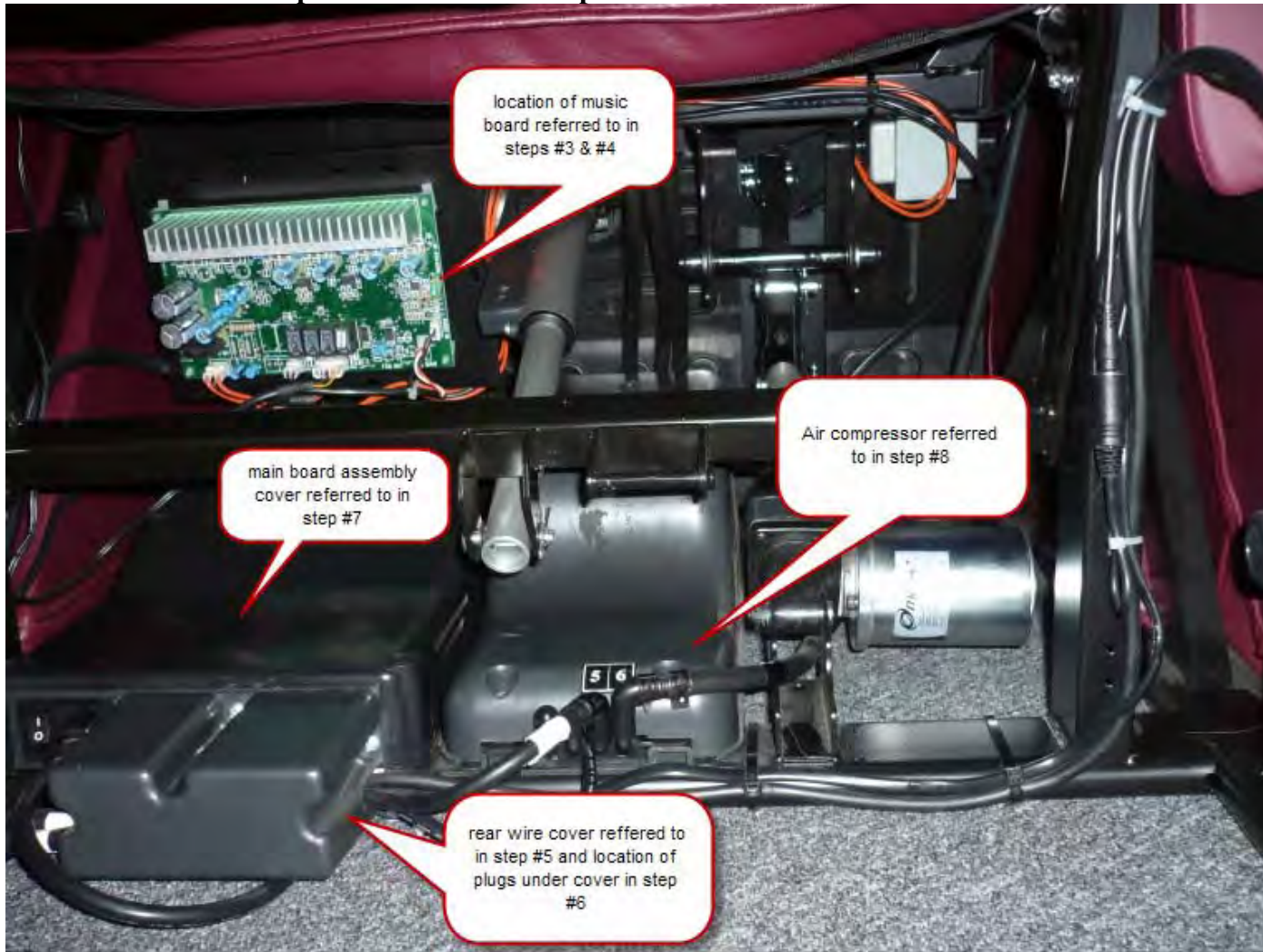

Step 3) Remove cover for music board



Step 4) Disconnect the wire marked “MAIN” on music board. If unsure, it is the wire that originates from the hole in the cover below the music board. Cut the zip ties holding the wire.

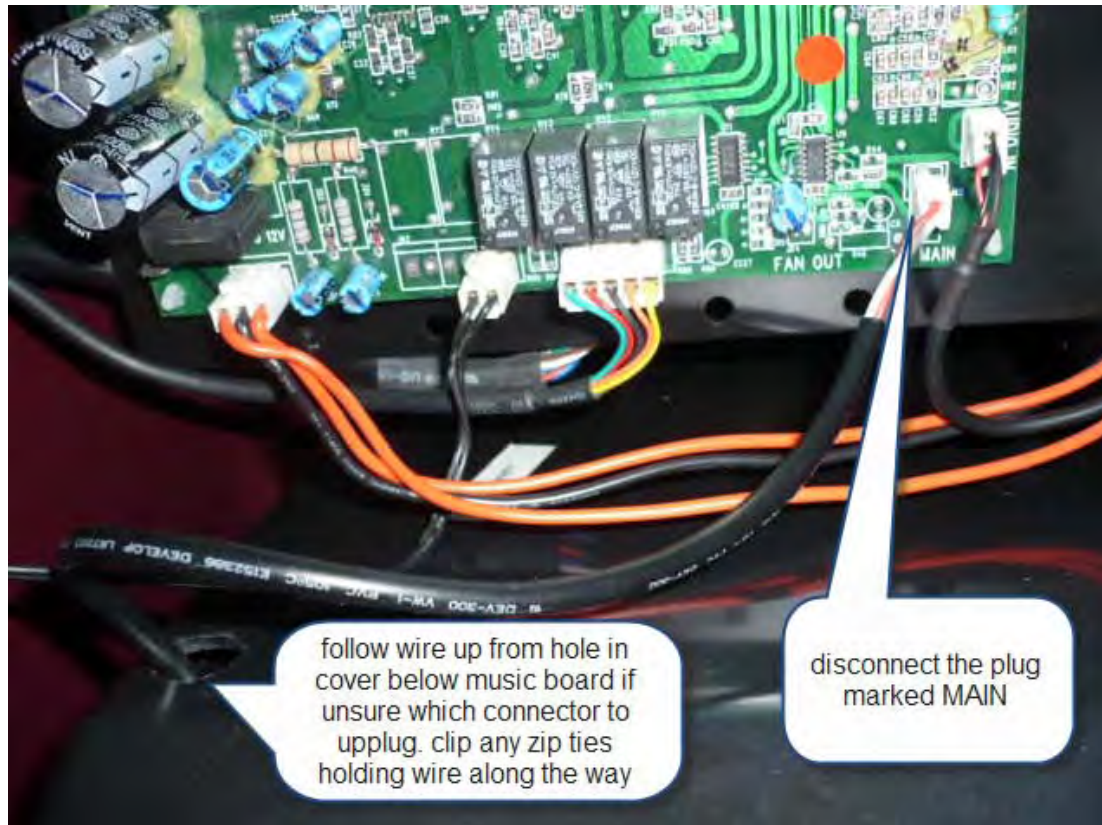

Step 5) Remove the 5 screws holding the rear wire cover in place.

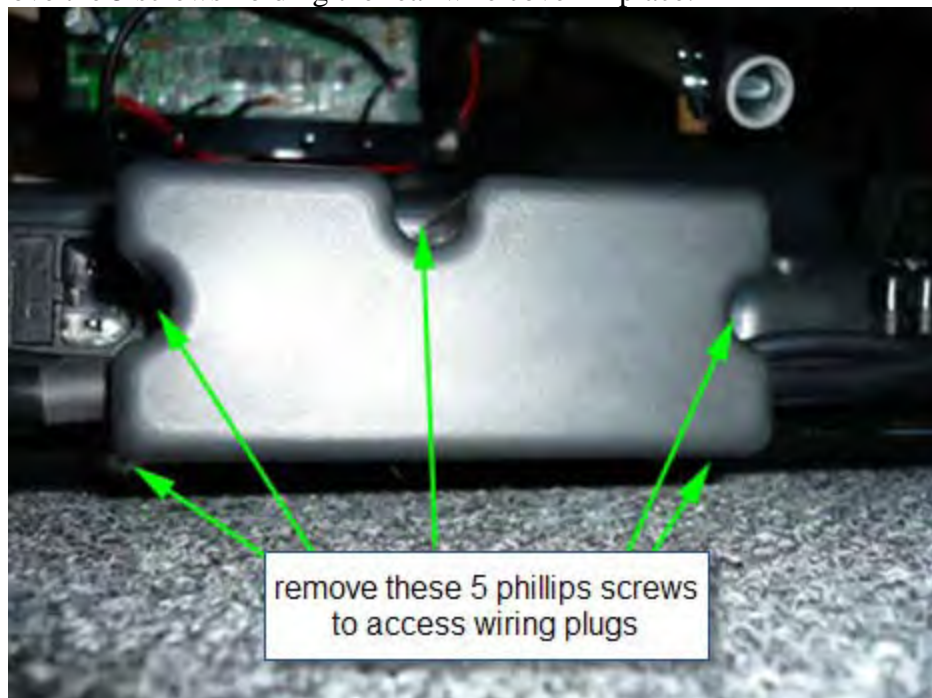

Step 6) Remove the 3 wires plugged into the back of the main PCB assembly and cut the zip tie and unplug the wire leading to the air compressor.

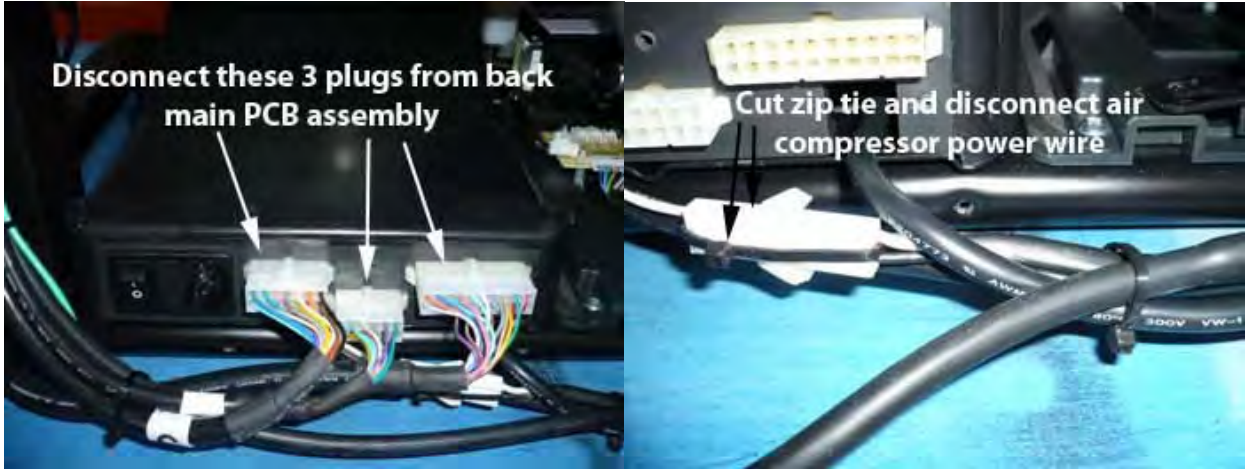

Step 7) Remove the 2 screws from back of board cover and 1 from the front. Once all 3 screws have been removed, lift board cover off feeding music wire (step 4) through hole in top of cover.



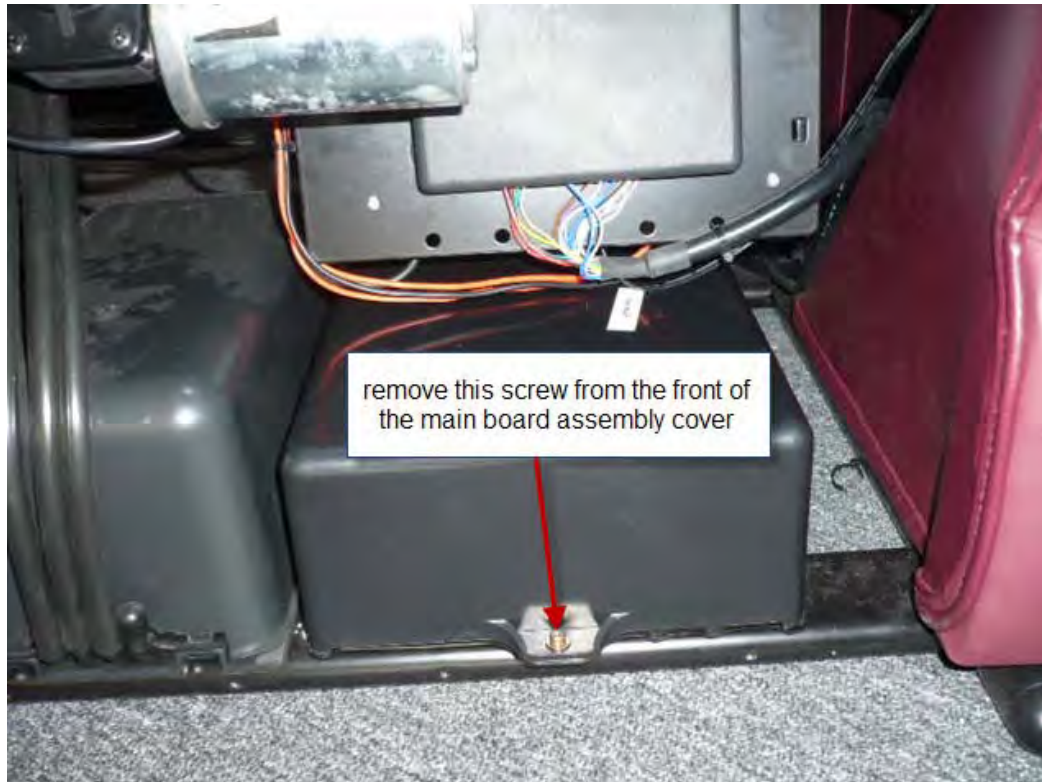

Step 8) Remove the cover to the air compressor then remove cable coming from the main controller into compressor assy.

- a) Remove the screws holding the cover on the compressor. It may be easier to get access to the screws if you recline the backrest just an inch or two.

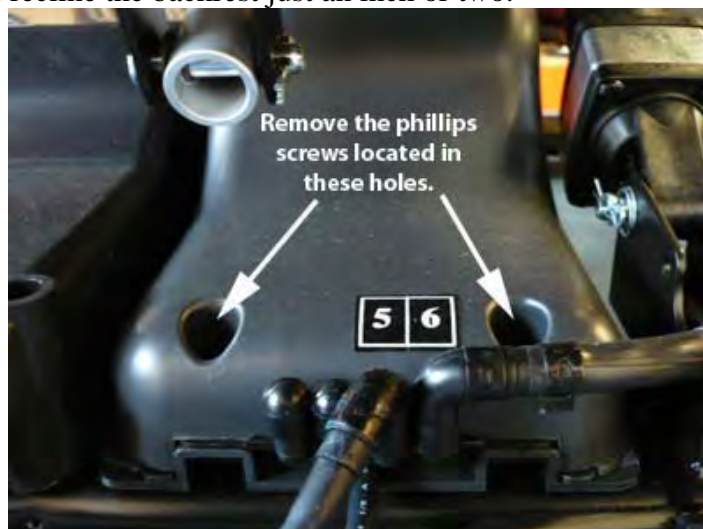



push recline until bar moves out of the way

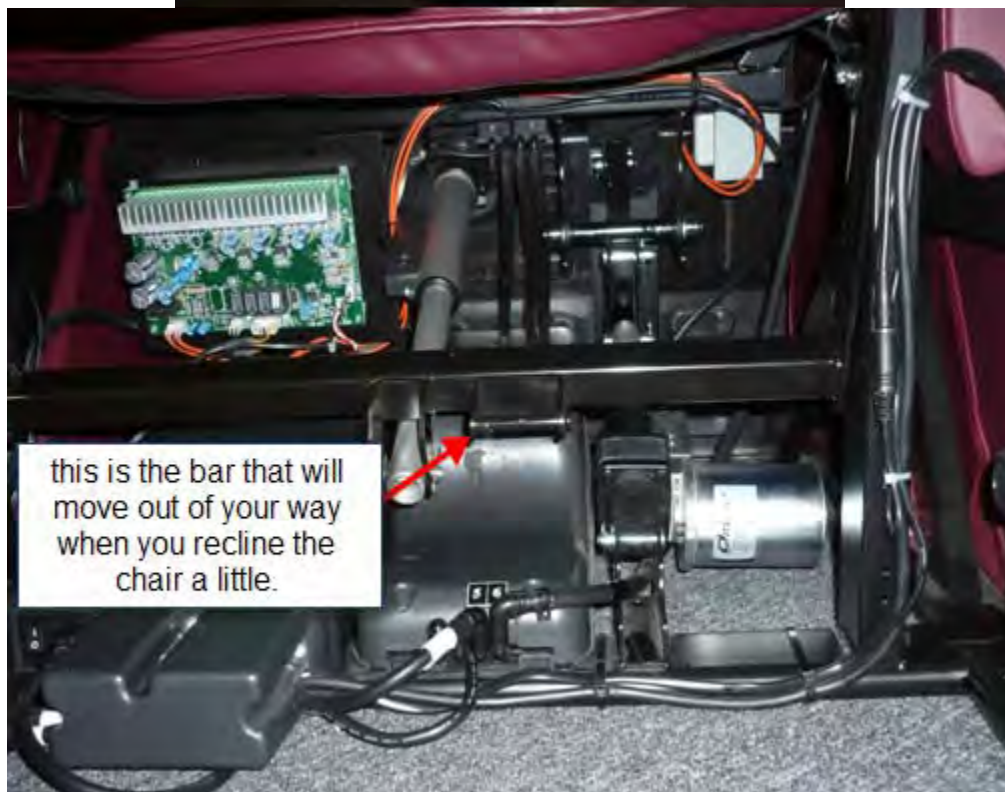

this is the bar that will move out of your way when you recline the chair a little.

b) Remove the cover by lifting up to release front lock tabs and sliding out from front of chair.



c) Unplug the wiring harness from the air compress expansion board.

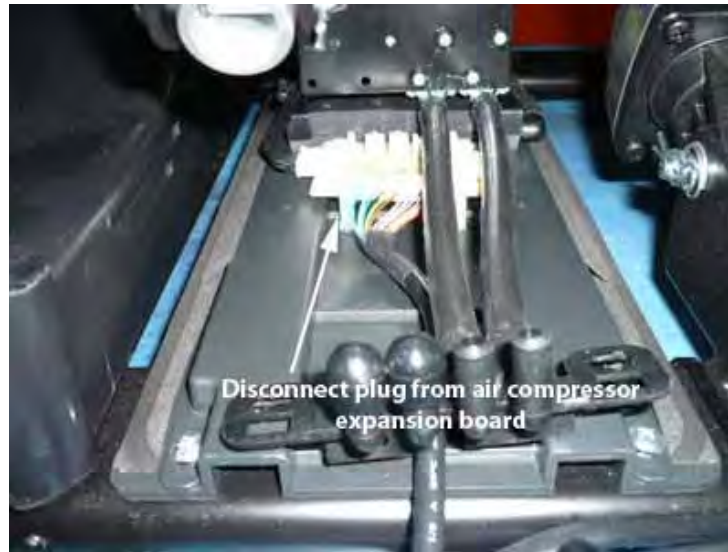

Step 9) Cut all zip tied holding remote cord to chair frame and bring remote & cord to back of chair.



Step 10) Remove 2 Phillips screws holding the rear of the board base to the chair frame. These are located just behind the plugs referred to in step #6. Then remove the 3 Phillips screws in the front of the main board that also secure it to the frame.



Step 11) Slide the Main PCB assembly out of chair through the front. Send in the entire main board assembly, putting the cover back on to protect in shipping, leaving the remote control attached and include the power cord that goes from the chair to the surge protector or outlet.

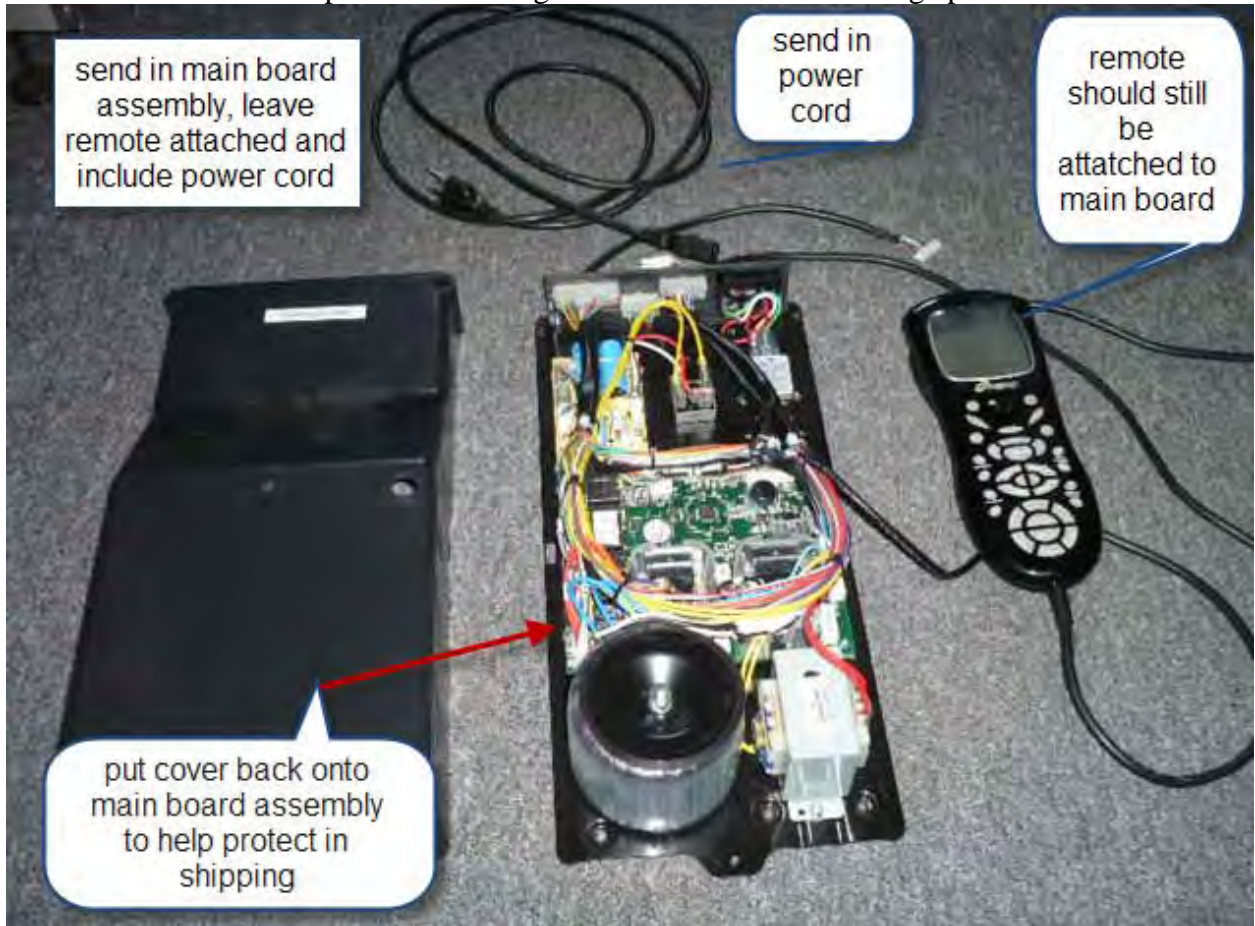

Step 11) Reverse these instructions for reassembly.